

Cyclone Vertical LED Fogger (CF-9.0)

CF-9.0



Save this instruction properly
Every information is subject to change without prior notice

CONTENTS

Warning..... 1

Caution..... 3

Particular Warning..... 4

Please Note 4

Important..... 4

Figure 1 Cyclone Vertical LED Fogger Functions 5

Description 6

Getting Ready 6

Mounting 7

Set Up 9

Functions of the buttons 10

Operation 12

Figure 2 DMX Chart 15

Figure 3 Color Macro List..... 16

Troubleshooting 19

Maintenance..... 19







Product Specifications 20

Appendix – A RC-4CB 21

Specification of compatibale controllers 22

If the supply cord is damaged, it must be replaced by the manufacturer, its service agent or similarly qualified persons in order to avoid a hazard.

Instructional icons

	Read the manual
	Indoor use only
	This symbol indicating separate collection for electrical and electronic equipment
	Warning: situations that could cause injury to yourself or others
	Caution: situations that could cause damage to your machine or other equipment
	Note: notes, usage tips, or additional information

Thank you for selecting our Cyclone Vertical LED Fogger, you already own the high-tech, professional DMX Fogs! Better read the manual thoroughly before operation, follow instruction will help you have a smooth handling with Cyclone Vertical LED Fogger to achieve the most satisfactory fog effect, it will also assist unit to further prolong life time as a whole.

Warning!



Like all electronic products, Cyclone Vertical LED Fogger must be used with safety precautions in mind.



Fill enough fog fluid before plugging in, empty fluid tank when not in use or moving.

- Use only appropriate, grounded electric power supply for your unit. See your product specification label for appropriate power supply. This appliance must be earthed.
- Disconnect from electric mains power supply when not in use, when filling the fog fluid tank, or when changing a fuse. Keep unit dry. If moisture or liquids enter the fog machine case, immediately disconnect power supply. Contact a service technician to determine safety for use.
- Keep machine in flat position, never put it in tilted place.

- Before moving fog machine, always drain fog fluid into the tank and tighten the tank cap securely to avoid spilling.
- Without user-serviceable parts in the package, please contact your local agent or qualified technician for servicing.
- Without changeable structure by non-qualified user, please do not open the up cover or have any change at will, otherwise, it may cause accident!
- Fog machine is for adult use. Keep out of reach of children. Never leave the unit running unattended.
- Fog machine nozzle gets hot over 200 degrees (centigrade) during use. Don't touch! Maintain a safe distance over 100CM. Never aim the nozzle directly at people.
- Keep case closed while operating. Put fog machine in drafty place. Do not insert objects into air vents. Allow 20cm space or above around the machine for proper ventilation.
- Keep fog machine away from flames and flammable items. Never aim the nozzle at open flames or sparks. Use only high quality water-based fog fluid. Never put flammable substances into the tank.
- Machine must cool down before cleaning, servicing or storing.
- Never put any flammable material (lipid, gas, perfume etc.) into the tank, read the user manual thoroughly before operation.



- In the warm-up is completed, the green LED light up period, if the receiver receives a valid signal emitted by the transmitter, the green LED off. If the transmitter stop signal, then restore the green LED lights while stopped puffing smoke.
- The fog machine is off emission for about 9 minutes during warm-up and re-heating cycles (about 80 seconds), and turns on when the temperature reached again.

Important Remark

When the green LED on the controller lights up, it does not mean that the machine has got completely heated, but just means that the machine reaches an enough temperature for fogging.

Check the red dot in the middle of CH.A (or others like CH.b etc.) on the LED display to know whether the machine has completed heating up or not.

If the red dot is flashing, heating is not completed yet, and duration of fogging is only 1-3 seconds. If the red dot is lighted and does not flash, heating is completed, and duration of each fogging can reach 8-9 seconds.

Specification of Compatible Controllers

Model	RC-4CB
Cable Length	Wireless
Effective Distance (open space, no barrier)	Up to 30 m
Connector	1/4" stereo jack
Function	Control 4 color macros
Dimension (LxWxH)	Receiver 91×58×29mm with 600mm cable (stereo jack included) Transmitter 63×39×14mm
Weight	Receiver 85g / Transmitter 31g

- Better use our high quality water-based fog fluid, random use with other fog fluid may jam the pipe, or even erode the components inside.
- Keep sufficient fog fluid in tank. Operating the unit without sufficient fog fluid, the pump will stop working.
- If any abnormal running occurs, stop it immediately, empty the fluid, and bring the done up unit (recommend original box) to your agent or dealer for servicing. Make sure all fluid is empty from the tank before moving or shipping.
- Never drink fog fluid. If ingested, call a doctor immediately. If fluid contacts eyes or skin, rinse skin thoroughly with water.
- Read user manual instructions thoroughly before operating. Follow the instruction. Never remove warning or informative labels from the unit.



IMPORTANT SAFEGUARDS

- Read all instruction
- Products for indoor use only. Keep away from liquids. Never operate in rain or in damp conditions.
- Unit must be grounded.
- Don not open unit, risk of electric shock.
- Keep machine in flat position, never put it in tilted place.
- Do not immerse in any liquid
- Save these instructions.



Caution!

There are no user serviceable parts inside this unit. Do not attempt any repairs yourself, doing so will void your manufactures warranty. In the unlikely event your unit may require service please contact your local dealer.



Particular Warning :

Please install the product correctly according to the instruction of the user manual. To avoid any accident, it is not allowed to install the product with any way not instructed on the user manual. If accident happens because users do not install the product according to the instruction of the user manual, the manufacturer will not take any responsibility.



Please note:

Specifications and improvements in the design of this unit and this manual are subject to change without any prior written notice.

Important

The wires in this mains lead are colored in accordance with the following code.



EU

Green and Yellow – Earthed (E)

Blue – Neutral (N)

Brown – Live (L)

Warning: This appliance must be earthed.

USA

Green and Yellow – Earthed (E)

White – Neutral (N)

Black – Live (L)

Warning: This appliance must be earthed.

Appendix – A RC-4CB

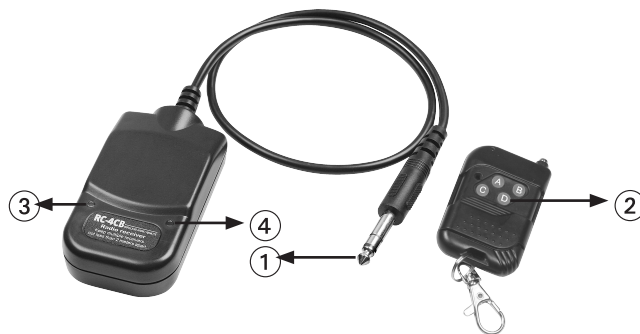

1. 1/4" stereo jack

2. Button

3. Green LED (fog)

4. Red LED (power)

Wireless Remote Control Operation:

The Cyclone Vertical LED Fogger is designed with wireless remote controller. Workable remote distance possibly extends to 30 meters. Detail operation as bellows;

A. Four-channel wireless remote control transmitter:

Key A, B, C, D respectively "CH.A, CH.b, CH.c, CH.d". Each channel can be individually set its Color Marco (see "SYSTEM MENU" instruction) by menu of the machine. Send smoke signals when the button is pressed, release the button to stop smoke.

B. Receiver:

- Red LED: Power indication. Once the fog machine is plugged, the red LED on this receiver of remote controller will light up. Unplug the power, the red LED off.
- Green LED: Status indication.
 1. Warm-up, the green LED goes out.
 2. Warm-up is completed, the green LED light up.

- PC board should be kept from being dirtied with oil. In case this happened, dismantle carefully the PCB, and have it brushed clean both sides with dilute alcohol. Leave it dry itself, then install it back. Make sure all wires are well connected.
- Clean the metal cover with dry cloth.

Product Specifications

Name	Cyclone Vertical LED Fogger
Item No.	CF-9.0
Heater Power	1450W
Consumption	1550W
FUSE(120V)	NFB 16A
FUSE(230V,240V)	T10A/250V (IEC)
Warm Up time(min)	9
Fog Output (cu.ft/min)	40000
Fluid Consumption (ml/min)	150ml/min
Display	LED
Tank (liters)	2.5L
LED	7x3W RED LED 7x3W GREEN LED 9x3W BLUE LED 3x3W Amber LED
DMX512 CH.	1CH, 2CH, 3CH, 5CH, 7CH or 9CH
Handle	YES
Dimensions/mm (LxWxH W/Handle)	419x315x206
Weight (kg)	9.5
Voltage	120V,230V,240V 50/60Hz
Matching Controller (Included)	RC-4CB

* Voltage is preset at the factory and may not be changed.

Figure1 Cyclone Vertical LED Fogger Functions

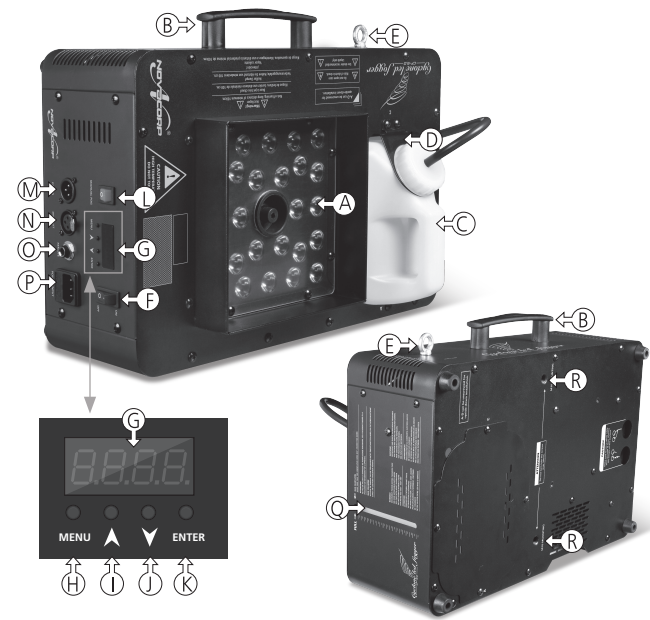

- | | |
|--------------------|---|
| A. 26 LEDs | J. Down |
| B. Handle | K. Enter |
| C. Fog Fluid Tank | L. Manual Fog |
| D. Tank Fixed Ring | M. DMX 3 pin XLR Input |
| E. Safety Loop | N. DMX 3 pin XLR Output |
| F. Power Switch | O. Control Socket Connection |
| G. LED display | P. Electric Power Cord with Fuse Holder |
| H. Manu | Q. Visible Fog Fluid Level Indicator |
| I. Up | R. M10*P1.5 C Clamp Installation |

Description

Cyclone Vertical LED Fogger (CF-9.0)

- Built-in function of led lighting control allows easy control led patterns through by LED display. Like flames, burst etc. LED could be turn on separately without fog output under DMX operation mode.
- When hanging CF-9.0 upside down, just loosen the screws of the tank fixed ring and back board to change the position of the tank.
- Visible fog fluid level indicator on rear.
- Special instant stopping function, CO2 effect alike.
- DMX on board, 6 DMX modes for choice; 1CH, 2CH, 3CH, 5CH, 7CH & 9CH, operate by any additional DMX controller.
- Manual fogging can be operated directly from the back panel of the machine.
- Aluminum die-cast design functioned with high-effective heating module prevents clogging. Unique design that can be earthed directly without affecting normal working of the thermo system and DMX control circuit. There won't be danger of accidental human body's electric shock.
- High output fog machine, approx. 40,000 cu.ft/min output.
- Electronic Thermo Sensing (ETS) – electronic heater stay hot at all times between fog blasts.
- Direct thermal protection.
- Operate by wireless controller (RC-4CB). Simple and humanized design makes CF-9.0 easier for use.

Getting Ready

All products are thoroughly tested at the factory and shipped in perfect condition. If damage has occurred during shipping, or if components are missing, please contact your local dealer immediately.

Your package should include:

- ❶ One Cyclone Vertical LED Fogger
- ❷ One Wireless controller
- ❸ One product user manual

Troubleshooting

This troubleshooting guide is meant to help solve simple problems. If a problem occurs, carry out the steps below in sequence until a solution is found. Once the unit operates properly, do not carry out following steps. If the problem persists, refer servicing to a qualified technician.

Power Connected but No Fog Is Emitted

1. Check the power supply. Plug the unit into grounded electric power supply socket with proper voltage.
2. Check your controller if in correct connection, test the battery if power enough for wireless controller.
3. Check your DMX address setting.
4. Disconnect fog machine from electric power supply. Replace fuse with one of the same type.

Other Abnormal Situations that Could Make Heater & Pump Stop Working

- Flashing and showing "Error" means heater is too hot or thermos sensor is cut.

Maintenance

Before doing maintenance, please make sure that the power is cut, the power cord is unplugged, and the machine itself has cooled down. The maintenance must be done by qualified person.

- The fog liquid is not allowed to get dirty. Be sure to always clean or replace the caps on the fog liquid vessel and tight the cover of the fog machine liquid tank immediately after filling.
- Periodically check the connections among the oil tube, the pump and the heater to see if there's oil leaking. If positive, lock tight the connections carefully with proper tool.

64-71	Red_1 = 255 Green_1 = 0 Blue_1 = 0 Amber = 0	Red_2 = 0 Green_2 = 255 Blue_2 = 0	192-199	Red_1 = 0 Green_1 = 142 Blue_1 = 0 Amber = 200	Red_2 = 88 Green_2 = 48 Blue_2 = 200
72-79	Red_1 = 0 Green_1 = 0 Blue_1 = 255 Amber = 255	Red_2 = 0 Green_2 = 0 Blue_2 = 0	200-207	Red_1 = 255 Green_1 = 0 Blue_1 = 0 Amber = 0	Red_2 = 255 Green_2 = 0 Blue_2 = 0
80-87	Red_1 = 0 Green_1 = 255 Blue_1 = 0 Amber = 0	Red_2 = 255 Green_2 = 0 Blue_2 = 0	208-215	Red_1 = 0 Green_1 = 255 Blue_1 = 0 Amber = 0	Red_2 = 0 Green_2 = 255 Blue_2 = 0
88-95	Red_1 = 128 Green_1 = 100 Blue_1 = 50 Amber = 0	Red_2 = 77 Green_2 = 0 Blue_2 = 165	216-223	Red_1 = 0 Green_1 = 0 Blue_1 = 255 Amber = 0	Red_2 = 0 Green_2 = 0 Blue_2 = 255
96-103	Red_1 = 77 Green_1 = 210 Blue_1 = 56 Amber = 234	Red_2 = 77 Green_2 = 0 Blue_2 = 0	224-231	Red_1 = 0 Green_1 = 0 Blue_1 = 0 Amber = 255	Red_2 = 0 Green_2 = 0 Blue_2 = 0
104-111	Red_1 = 82 Green_1 = 0 Blue_1 = 99 Amber = 50	Red_2 = 134 Green_2 = 0 Blue_2 = 222	232-239	Red_1 = 255 Green_1 = 255 Blue_1 = 255 Amber = 255	Red_2 = 255 Green_2 = 255 Blue_2 = 255
112-119	Red_1 = 0 Green_1 = 79 Blue_1 = 0 Amber = 220	Red_2 = 210 Green_2 = 50 Blue_2 = 50	240-247	Random_1	
120-127	Red_1 = 63 Green_1 = 75 Blue_1 = 0 Amber = 44	Red_2 = 145 Green_2 = 166 Blue_2 = 100	248-255	Random_2	

Mouting

Particular Warning: Please install the product correctly according to the instruction of the user manual. To avoid any accident, it is not allowed to install the product with any way not instructed on the user manual. If accident happens because users do not install the product according to the instruction of the user manual, the manufacturer will not take any responsibility.

Cyclone Vertical LED Fogger (CF-9.0) can only be set right way, upside down way, and sideways.

1. Upside down way:

Loosen the few screws of the tank fixed ring, replace the tank down to the bottom, then put the tank fix ring to the tank again, and tighten the screws.

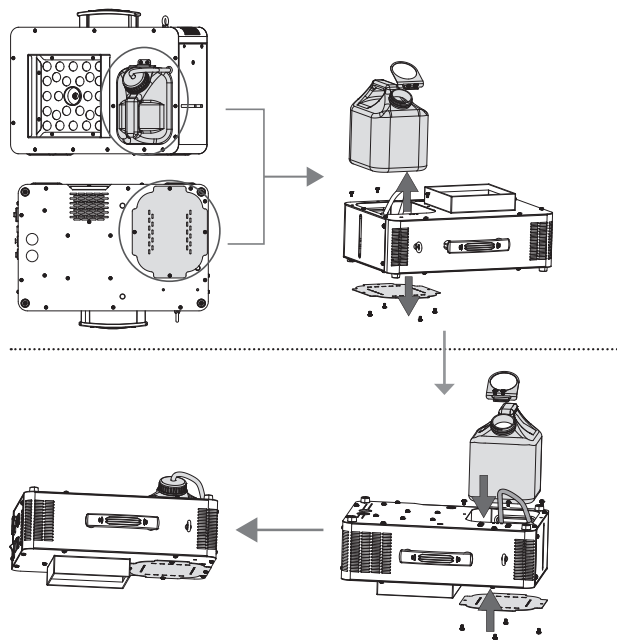

Fasten the CF-9.0 onto firm trussing (Use a 15-kg rated or stronger C-clamp bolted onto bottom of CF-9.0, enhancing safety necessarily with safety cables). Leave at least one meter at all sides for air circulation.

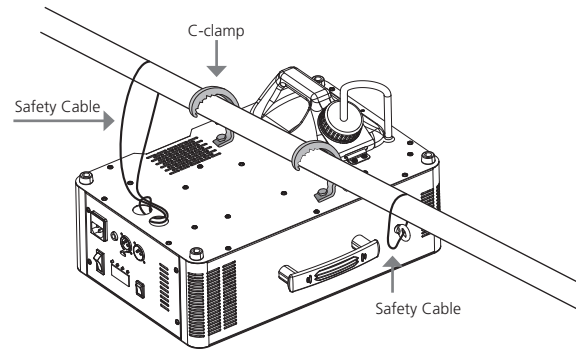

2. Side way:

Please set CF-9.0 as photo's position. Fasten the CF-9.0 onto firm trussing (Use a 15-kg rated or stronger C-clamp bolted onto bottom of CF-9.0, enhancing safety necessarily with safety cables). Leave at least one meter at all sides for air circulation.

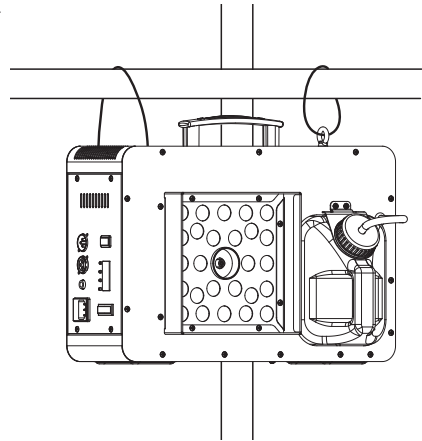

Figure 3 Color Macro List

Value	Color		Value	Color	
0-7	OFF		128-135	Red_1 = 185	Red_2 = 100
				Green_1 = 55	Green_2 = 70
				Blue_1 = 233	Blue_2 = 167
				Amber = 0	
8-15		Red_1 = 255 Green_1 = 0 Blue_1 = 0 Amber = 0	136-143	Red_2 = 0	Red_2 = 25
				Green_2 = 0	Green_2 = 32
		Blue_2 = 0		Blue_1 = 18	Blue_2 = 177
				Amber = 255	
16-23		Red_1 = 0 Green_1 = 255 Blue_1 = 0 Amber = 0	144-151	Red_2 = 0	Red_2 = 0
				Green_2 = 0	Green_2 = 125
		Blue_2 = 0		Blue_1 = 0	Blue_2 = 125
				Amber = 33	
24-31		Red_1 = 0 Green_1 = 0 Blue_1 = 255 Amber = 0	152-159	Red_2 = 0	Red_2 = 0
				Green_2 = 0	Green_2 = 200
		Blue_2 = 0		Blue_1 = 200	Blue_2 = 139
				Amber = 0	
32-39		Red_1 = 0 Green_1 = 0 Blue_1 = 0 Amber = 255	160-167	Red_2 = 45	Red_2 = 122
				Green_2 = 0	Green_2 = 0
		Blue_2 = 0		Blue_1 = 156	Blue_2 = 77
				Amber = 0	
40-47		Red_1 = 0 Green_1 = 255 Blue_1 = 0 Amber = 0	168-175	Red_2 = 200	Red_2 = 177
				Green_2 = 0	Green_2 = 0
		Blue_2 = 255		Blue_1 = 235	Blue_2 = 220
				Amber = 0	
48-55		Red_1 = 255 Green_1 = 0 Blue_1 = 0 Amber = 0	176-183	Red_2 = 80	Red_2 = 55
				Green_2 = 0	Green_2 = 55
		Blue_2 = 255		Blue_1 = 44	Blue_2 = 166
				Amber = 255	
56-63		Red_1 = 255 Green_1 = 0 Blue_1 = 0 Amber = 255	184-191	Red_2 = 130	Red_2 = 75
				Green_2 = 222	Green_2 = 170
		Blue_2 = 0		Blue_1 = 28	Blue_2 = 195
				Amber = 111	

7CH MODE.....

CH1	CH2	CH3	CH4	CH5	CH6	CH7
FOG	RED	GREEN	BLUE	AMBER	STROBE	MASTER DIMMER
32-255 MAX FOG	1-255 MIN to MAX	1-255 MIN to MAX	1-255 MIN to MAX	1-255 MIN to MAX	160-255 Random Strobe (Slow>Fast)	1-255 MIN to MAX
0-31=OFF	0=OFF	0=OFF	0=OFF	0=OFF	96-159 Pulse-Effect in sequence	0=OFF
					32-95 Strobe Effect (Slow > Fast)	
					0-31 Strobe Off	

9CH MODE.....

CH1	CH2	CH3	CH4	CH5	CH6	CH7	CH8	CH9
FOG	RED1	GREEN1	BLUE1	AMBER	RED2	GREEN2	BLUE2	MASTER DIMMER
32-255 Max Fog	1-255 MIN to MAX	1-255 MIN to MAX	1-255 MIN to MAX	1-255 MIN to MAX	1-255 MIN to MAX	1-255 MIN to MAX	1-255 MIN to MAX	1-255 MIN to MAX
0-31=OFF	0=OFF	0=OFF	0=OFF	0=OFF	0=OFF	0=OFF	0=OFF	0=OFF

Set Up

1. Open the shipping carton and carefully remove the unit from the shipping carton.
2. Be sure to remove packing material from around the fog machine, especially near the nozzle.
3. Set the fog machine on a dry, flat surface.
4. Place the feeder tube with filter deep inside the full fog fluid tank (C of figure1). Use only high quality, water-based fog fluid.
5. Firmly attach the remote control mechanism to socket (O of figure1) on the back of the unit. Or use DMX control setting (H of figure1) on the back of the unit.
6. Plug mains power cord from the fog machine into appropriate power supply socket. Wait about 9 minutes for heating element to heat up.
7. Refer to your controller manual for operation details. (Appendix A)
8. If fog is emitted continuously for a long time, the heating element temperature may drop, shutting off fog production. If so, please do not activate for emission. Wait briefly. When the heating element temperature rises, fog emissions can be resumed.

Functions of the buttons

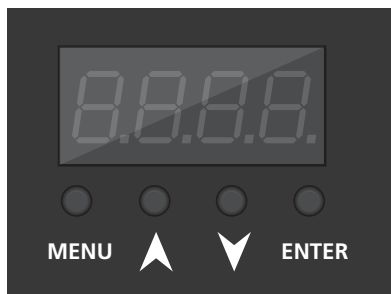

MENU: Button for color macro setting of each channel, and DMX address setting.

ENTER: Button for switch the first layer and the second layer of menu.

UP: Button for increasing numerical value

DOWN: Button for decreasing numerical value
Press "**UP**" or "**Down**" 15 seconds can change value continuously and fast.

Figure 2 DMX Chart

1CH MODE.....

CH1
FOG & CH.A COLOR MACRO
32-255 = MAX FOG, Random Color Chang
0-31=OFF

2CH MODE.....

CH1	CH2
FOG	COLOR MACROS
32-255 = MAX FOG	Color Macro 1~29 (please see figure 3 - color macro list)
0-31=OFF	

3CH MODE.....

CH1	CH2	CH3
FOG	COLOR MACROS	STROBE
32-255 = MAX FOG	Color Macro 1~29 (please see figure 3 - color macro list)	160-255 Random Strobe (Slow>Fast)
0-31=OFF		96-159 Pulse-Effect in sequence
		32-95 Strobe Effect (Slow > Fast)
		0-31 Strobe Off

5CH MODE.....

CH1	CH2	CH3	CH4	CH5
FOG	RED	GREEN	BLUE	AMBER
32-255 MAX FOG	1-255 MIN to MAX	1-255 MIN to MAX	1-255 MIN to MAX	1-255 MIN to MAX
0-31=OFF	0=OFF	0=OFF	0=OFF	0=OFF

4. 2 seconds after it switches to working status: Heating up, it shows "HEAT". Setting function value is allowed when heating up. With no operation after 4 seconds, it goes back to "HEAT" status.
5. Wait about 9 minutes for heating element to heat up.
6. There are 6 DMX modes for choice; 1CH, 2CH, 3CH, 5CH, 7CH, & 9CH please choose the mode by menu: It shows "d1" to "d9".
7. When completed heating, it shows control mode: It shows ".dx" or "R.xxx", please set the unit to the desired DMX512 address, and DMX control available, wireless control not available. Your CF-9.0 is now ready for operation with your DMX controller.
8. If desired, connect another fog machine: Plug one end of another signal cable in to the output socket (N of figure 1) on the back of the first CF-9.0; plug the other end of the signal cable to the input socket on the back of the second CF-9.0. Follow the same procedure to link more fog machine, if desired; whole link is daisy chain.

-  Manual fogging could be work with DMX control operation at the same time.
- When shot down, the present function status will be saved automatically and continue when Powered on next time.
 - If the red dot before the letters or in the middle of the letters (.dx or R.xxx) on the display is flashing, heating is not completed yet, and duration of fogging is only 1-3 seconds. If the red dot is lighted and does not flash, heating is completed, and duration of each fogging can reach 8-9 seconds.

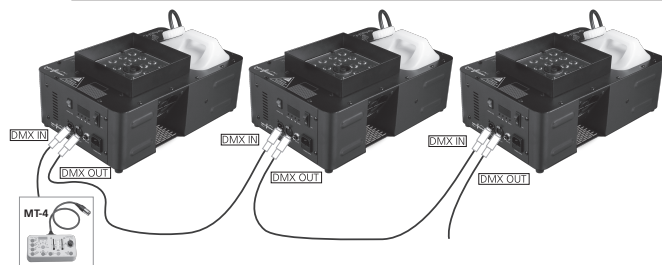

SYSTEM MENU

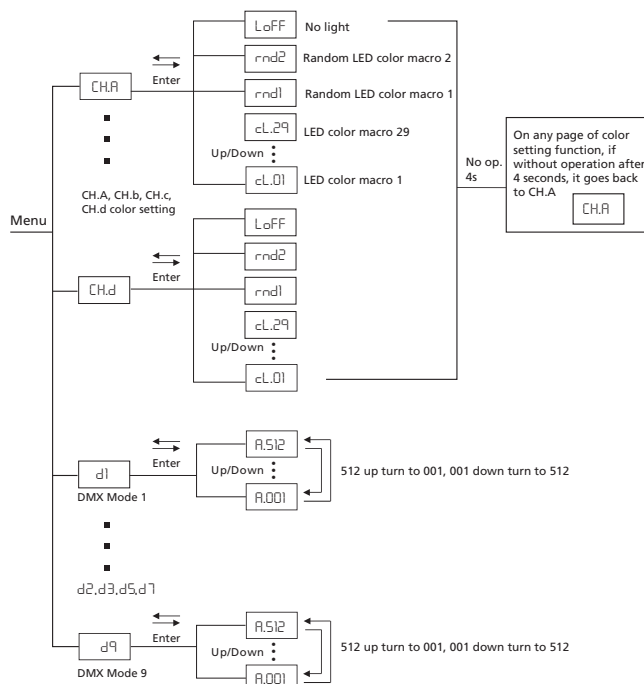

- When shot down, the present function status will be saved automatically and continue when powered on next time.

Operation

Stand-alone.....

Please put the Cyclone Vertical LED DMX Fogger on a dry and flat surface.

1. Plug mains power cord from the fog machine into appropriate power supply socket.
2. Primary power on, LED display (G of figure 1) shows “8.8.8.8.”, and 26 LEDs (A of figure 1) around the nozzle all light up. Please check if the LED letters shown on the display lack of strips, and then show the current software version.
3. 2 seconds after it switches to working status: Heating up, it shows “HEAT”. Setting function value is allowed when heating up. With no operation after 4 seconds, it goes back to “HEAT” status.
4. Wait about 9 minutes for heating element to heat up.
5. Push the Manual Fog button (L of figure1) to smoke.



- Manual fogging is available under any control mode and always executing the Color Macro of CH.A.

Remote Control Operation.....

For best result, use RC-4CB wireless controller.

1. Firmly attach the remote control to socket (O of figure1) on the back of the unit.
2. Plug mains power cord from the fog machine into appropriate power supply socket.
3. LED display (G of figure 1) shows “8.8.8.8.”, and 26 LEDs (A of figure 1) around the nozzle all light up. Please check if the LED letters shown on the display lack of strips, and then show the current software version.
4. 2 seconds after it switches to working status: Heating up, it shows “HEAT”. Setting function value is allowed when heating up. With no operation after 4 seconds, it goes back to “HEAT” status.
5. Wait about 9 minutes for heating element to heat up.

6. Except “dx” and “R.x.x.x”, under any other status, wireless control is available while DMX control is not available.
7. Refer to your controller manual for controller operation details. (Appendix A)



- Manual fogging could be work with remote control operation at the same time.
- When shot down, the present function status will be saved automatically and continue when powered on next time.

Important Remark

When the green LED on the controller lights up, it does not mean that the machine has got completely heated, but just means that the machine reaches an enough temperature for fogging.

Check the red dot in the middle of CH.A (or others like CH.b etc.) on the LED display to know whether the machine has completed heating up or not.

If the red dot is flashing, heating is not completed yet, and duration of fogging is only 1-3 seconds. If the red dot is lighted and does not flash, heating is completed, and duration of each fogging can reach 8-9 seconds.

DMX Control Operation

Use LED Display to set the unit to the desired DMX512 address. Refer to DMX channel chart in Figure 2.

1. Connect the DMX 512 controller cable to the input socket (M of figure 1) of the fog machine unit. Make sure the signal cable polarity is correct.
2. Plug mains power cord from the fog machine into appropriate power supply socket.
3. LED display (G of figure 1) shows “8888”, and 26 LEDs (A of figure 1) around the nozzle all light up. Please check if the LED letters shown on the display lack of strips, and then show the current software version.